



# Showcase House Reference Guide

---

Presented by the Ohio Furniture Guild



## Design Revolution: Redefining Boundaries

Welcome to the Showcase House, where innovation meets inspiration. Each year, we strive to create more connections and push ourselves to stay ahead with our designs and colors. We're always thinking about ways to help your showroom stand out and stay fresh. The purpose of our Showcase House is to inspire Ohio builders to continually create innovative designs and showcase new colors. In this unique setting, you'll have the opportunity to appreciate how vastly different designs from different builders can be paired beautifully.

A crucial part of our vision lies in the artistry of finishes and color selections. We are proud to collaborate with Sherwin-Williams brands, M.L. Campbell, Autumn Mill, and Acroma Pro whose expertise in premium coatings and finishes brings depth, durability, and rich character to each design. Their commitment to quality ensures that every hue and texture enhances the natural beauty of the wood, seamlessly complementing the craftsmanship of each piece.

Through the selection process, our panel of judges curated pieces aligning with the 2025 theme categories:

- Woven elements
- Curved edges
- Innovation
- Elevated classics
- Highlighting the beauty of wooden hardware and grain patterns

As you tour this space, meticulously styled by S. Flynn Design, take notes on elements you can apply to your showroom to infuse inspiration with fresh designs and colors in your specific marketplace. We hope you will feel the allure and comfort of this home curated for you. Every individual involved, from the designers, builders, and finishers to the supporters, has collaborated over the past year to bring this vision to life. If you encounter them during your visit, share your thoughts – they'd be excited to hear from you.





## The Entry Room

We hope you feel at home as you enter our Showcase house. Each piece we've placed has a purpose to bring people together and enhance a home. Everything you will see has been masterfully crafted by the top Amish builders in Ohio, from their family to yours.





### BREEZE CHAIR

White Oak, Beach Front Stain  
C16-4 Giggling Fabric from Heartland Fabric

Designed by Ridge View Woodcraft | Booth D210



### APEX ROUND TABLE

White Oak  
Natural

Designed by Urban Barnwood | Booth A125



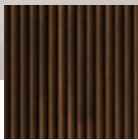

### MILLHOUSE BOOKCASE

Brown Maple

Lotus Silk

Designed by Genuine Oak Designs | Booth D194, D206







## The Living Room

For many, the living room has become the central hub of their home. The furniture we selected for this room highlights a sense of “togetherness” and natural warmth. The soft edges and tones make a clean and welcoming atmosphere for all who enter.

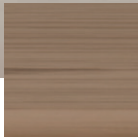
**DURHAM SOFA TABLE**

Red Oak

Painted SW-9172 Studio Clay

Designed by Urban Barnwood | Booth A125

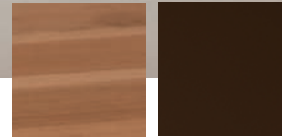
**CHAILI END TABLE**

Top: Brown Maple, Shade of Bark Stain

Base: Brown Maple, Painted SW-9605 Clove

Designed by Barkman Furniture | Booth D203





**HARMONY SOFA**  
White Oak, Warm Toffee Stain  
7-58 Latte Fabric from Heartland Fabric

Designed by Quality Fabrications | Booth C186



**JUPITER COFFEE TABLE**  
White Oak  
Morel Gray Stain

Designed by Kidron Woodcraft | Booth I373





### ANEKEE ARM CHAIR

Brown Maple, Shade of Bark Stain  
21055 Leather

Designed by Buckeye Seating | Booth E240



### MAXWELL CABINET

Inside: White Oak, Morel Gray Stain  
Outside: Brown Maple, Painted SW-9605 Clove

Designed by Red Barn Woodworking | Booth F268



### ALLENTOWN TV STAND

White Oak  
Warm Toffee Stain

Designed by Nisley Cabinet | Booth G299





A dining room with a wooden table and upholstered chairs. The table is set with plates, glasses, and a centerpiece of a vase with dried flowers. A chandelier hangs above the table. In the background, there is a sideboard with a wooden top and grey cabinets, and a window with sheer curtains. The room has a warm, inviting atmosphere with natural light coming from the window.

## The Dining Room

To elevate the classics, we've returned to sturdy hardwood builds. These pieces embrace wider frames and beautiful leg ornamentation. This is a dining room that harmonizes differences and focuses on reuniting the old with new - much like a family gathering around the table.



HOUSTON THREE DOOR BUFFET  
Base: Brown Maple, Painted SW-6259 Outdoor Space  
Top: White Oak, Perfect Brown Stain

Designed by Barkman Furniture | Booth D203

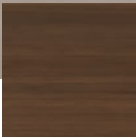

CARPENTER TABLE  
White Oak  
Perfect Brown Stain

Designed by Country Comfort Woodworking | Booth E235





### BROOKLYN SIDE CHAIR

Brown Maple, Early American Stain  
C8-58 Cane Fabric from Heartland Fabric

Designed by Urban Barnwood | Booth A125



## The Kitchen

Good food can be made in any kitchen, but it helps to have one full of all the bells and whistles. Our goal was to create a space that offered all the possible counter, drawer, and cabinet space for the average home. We hope the lovely atmosphere of this room will remind you of the sweet comforts of mom's cooking.





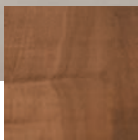

### HOUSTON ROUND TABLE

Brown Maple  
Provincial Stain

Designed by Barkman Furniture | Booth D203

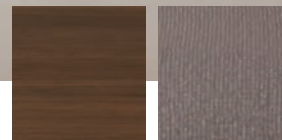

### LUNA SIDE CHAIR

Rustic QSWO, Perfect Brown Stain  
C2-20 Home Fabric from Heartland Fabric

Designed by Farmstead Acres Wood | Booth E241



### DESIGNER SERIES ISLAND

Base: Brown Maple, Painted SW-6089 Grounded

Top: Rustic QSWO, Warm Toffee Stain

Designed by Nisley Cabinet | Booth G299



### CAMBRIA STOOL

Rustic QSWO

Warm Toffee Stain

Designed by Country Comfort Woodworking | Booth E235





## The Office

This beautiful space was made with one goal in mind: organized productivity for the modern home. For this, we wanted to focus on clean rectangles and little ornamentation. The simple designs allow space for the mind and body to breathe, thus, opening an opportunity for creativity.



### CAMDEN END TABLE

Brown Maple  
Shade of Bark Stain

Designed by Nisley Cabinet | Booth G299

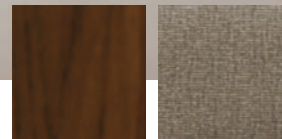

### HARPER ACCENT CHAIR

Red Oak, Warm Toffee Stain  
16-151 View Fabric from Heartland Fabric

Designed by Red Barn Woodworking | Booth F268





### MILLHALL FILE CABINET

Brown Maple

Painted SW-6259 Outer Space

Designed by Genuine Oak Designs | Booth D194, D206



### SIERRA EXECUTIVE CHAIR

Brown Maple, Shade of Bark Stain

21015-Slate Leather from Buckeye Fabrics

Designed by Premier Woodcraft | Booth B153



### ASHTON EXECUTIVE DESK

White Oak  
Beach Front Stain

Designed by Sharp Run Wood | Booth G283







## The Guest Bedroom

The guest room should be a fun and creative space that makes anyone feel at home. This layout mixed the great designs of the past with the modern simplicities of today. We believe we've achieved a bedroom that would make your guests want to come back for another stay.



CONTOUR DRESSER WITH MIRROR

White Oak

Captivating Brown Stain

Designed by Honey Run Woodcraft | Booth G289



BRYCE NIGHT STAND

Red Oak

Painted SW-9172 Studio Clay

Designed by Meadow Wood | Booth F263



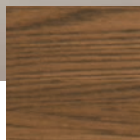

ST. AUGUSTINE QUEEN BED

White Oak  
Warm Toffee Stain

Designed by Troyer Ridge Furniture | Booth G305

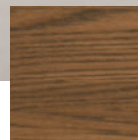

MILANO CHEVAL MIRROR

White Oak  
Warm Toffee Stain

Designed by Country Corner Woodworking | Booth E248

## The Kids' Room

Kids' grow up too quickly, their room should be able to grow with them. This room's highlight is its transitional crib. The design is centered on comfort and safety, and can easily convert into a toddler bed when the time comes.







### EUROPA CHEST OF DRAWERS

Brown Maple

Painted SW-0062 Studio Mauve

Designed by Farmside Wood | Booth D212

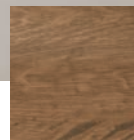

### TANNESSAH CRIB

Rustic QSWO

Smoke Stain

Designed by Kid's Comfort | Booth B152



## The Primary Bedroom

Is there anything greater than having an elegant and cozy space of your own? This Primary Bedroom was carefully pieced together to feature a rich, but simplistic environment that makes you relax the minute you walk through the door.



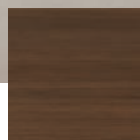

### MILLHALL NIGHT STAND

White Oak  
Perfect Brown Stain

Designed by Genuine Oak Designs | Booth D194, D206

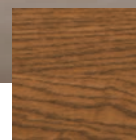

### MILLHALL KING BED

White Oak  
Captivating Brown Stain

Designed by Genuine Oak Designs | Booth D194, D206

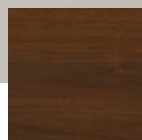

### GLENDALE DRESSER WITH MIRROR

Rustic Walnut

Captivating Brown Stain

Designed by Criswell Furniture | Booth B155





## Outdoor

Step outside, stretch your legs, and sink into a chair. Poly furniture has been making leaps and bounds over the past decade. Each piece we've showcased in this section has been manufactured for optimal comfort, low-maintenance, and longevity against the elements. Take it easy and relax.





### AURORA LOUNGE

Coastal Gray  
Direction Linen Fabric

Designed by Hershy Way | Booth F274

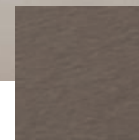

### AURORA COFFEE TABLE

Coastal Gray

Designed by Hershy Way | Booth F274





### CAPE MAY LOVESEAT

Black  
S40484-0001 Paradigm Stone Fabric

Designed by Backyard Designs | Booth G304



### HI BACK CHAIR WITH FOOTSTOOL

Coastal Gray  
Cast Ash Fabric

Designed by Siesta Outdoors | Booth D217



AURORA END TABLE

Coastal Gray

Designed by Hershy Way | Booth F274



ECLIPSE PUB TABLE

Coastal Gray

Designed by Hershy Way | Booth F274



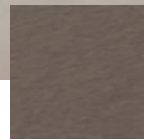

SHADOW SWIVEL CHAIR WITH FOOTSTOOL  
Coastal Gray

Designed by Hershy Way | Booth F274



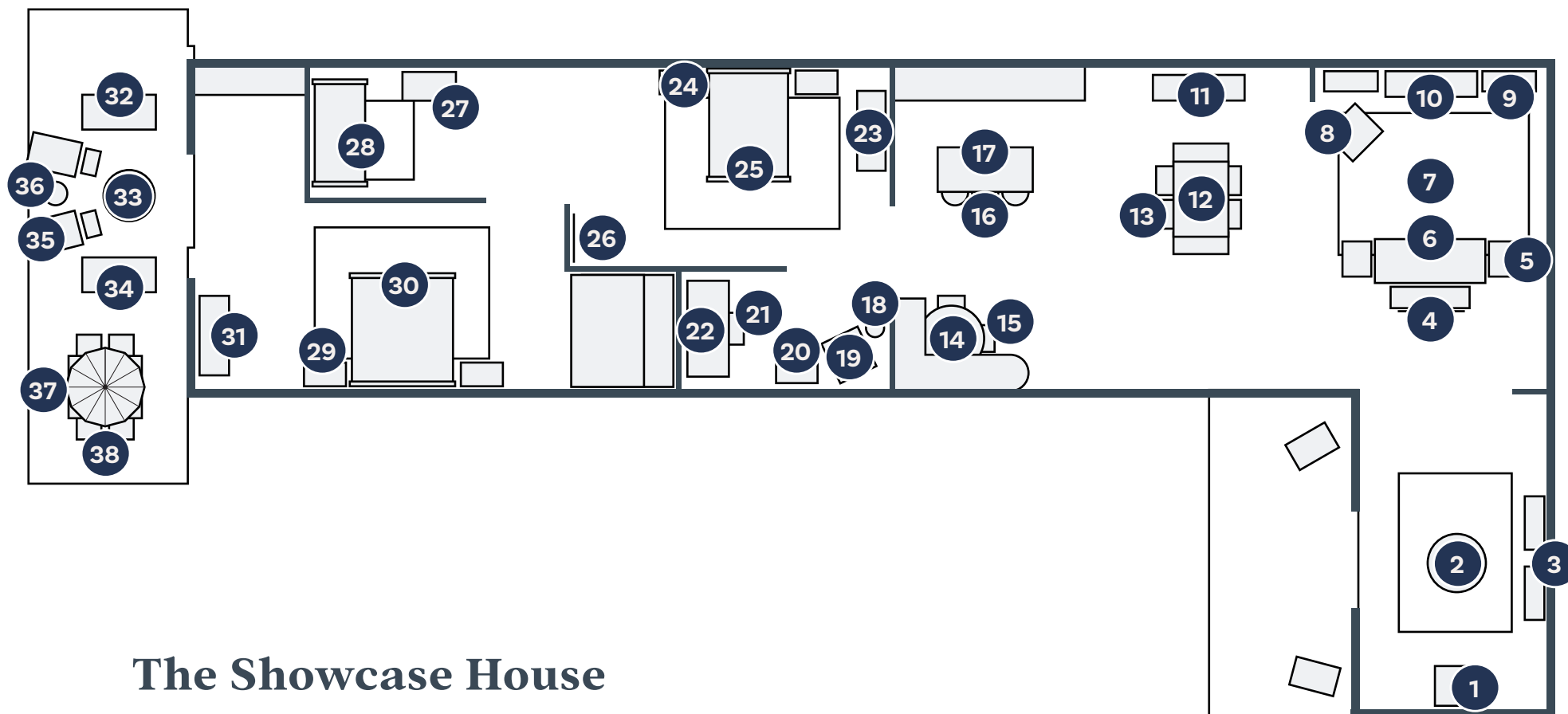

## The Showcase House

### ENTRY ROOM

- 1. Breeze Chair, page 6
- 2. Apex Round Table, page 7
- 3. Millhouse Bookcase, page 8

### LIVING ROOM

- 4. Durham Sofa Table, page 12
- 5. Chaili End Table, page 13
- 6. Harmony Sofa, page 14
- 7. Jupiter Coffee Table, page 15
- 8. Anekee Arm Chair, page 16
- 9. Maxwell Cabinet, page 17
- 10. Allentown TV Stand, page 18

### DINING ROOM

- 11. Houston Three Door Buffet, page 22
- 12. Carpenter Table, page 23
- 13. Brooklyn Side Chair, page 24

### KITCHEN

- 14. Houston Round Table, page 28
- 15. Luna Side Chair, page 29
- 16. Designer Series Island, page 30
- 17. Cambria Barstool, page 31

### OFFICE

- 18. Camden End Table, page 34
- 19. Harper Accent Chair, page 35
- 20. Millhall File Cabinet, page 36
- 21. Sierra Executive Chair, page 37
- 22. Ashton Executive Desk, page 38

### GUEST BEDROOM

- 23. Contour Dresser and Mirror, page 42
- 24. Bryce Night Stand, page 43
- 25. St. Augustine Queen Bed, page 44
- 26. Milano Cheval Mirror, page 45

### KIDS' ROOM

- 27. Europa Chest of Drawers, page 48
- 28. Tannessah Crib, page 49

### PRIMARY BEDROOM

- 29. Millhall Night Stand, page 52
- 30. Millhall King Bed, page 53
- 31. Glendale Dresser and Mirror, page 54

### OUTDOOR

- 32. Aurora Lounge, page 58
- 33. Aurora Coffee Table, page 59
- 34. Cape May Loveseat, page 60
- 35. Hi Back Chair with Footstool, page 61
- 36. Aurora End Table, page 62
- 37. Eclipse Pub Table, page 63
- 38. Shadow Swivel Chair, page 64





**BACKYARD DESIGNS**  
booth G304, Event Center



**BUCKEYE SEATING**  
booth E240, Event Center



**COUNTRY COMFORT WOODWORKING**  
booth E235, Event Center



**CRISWELL FURNITURE**  
booth B155, Event Center



**FARMSTEAD ACRES WOOD**  
booth E241, Event Center



**HERSHY WAY**  
booth F274, Event Center



**BARKMAN FURNITURE**  
booth D203, Event Center



**COUNTRY BEDDING**  
booth G302, Event Center



**COUNTRY CORNER WOODWORKING**  
booth E248, Event Center



**FARMSIDE WOOD**  
booth B155, Event Center



**GENUINE OAK DESIGNS**  
booth D194 and D206, Event Center



**HONEY RUN WOODCRAFT**  
booth G289, Event Center



**KIDRON WOODCRAFT**  
booth I373, Event Center



**NISLEY CABINET**  
booth G299, Event Center



**QUALITY FABRICATIONS**  
booth C186, Event Center



**RED BARN WOODWORKING**  
booth F268, Event Center



**SHARP RUN WOOD**  
booth G283, Event Center



**TROYER RIDGE FURNITURE**  
booth G305, Event Center



**MEADOW WOOD**  
booth F263, Event Center



**PREMIER WOODCRAFT**  
booth B153, Event Center



**RAINBOW BEDDING**  
booth A118, Event Center



**RIDGE VIEW WOODCRAFT**  
booth D210, Event Center



**SIESTA OUTDOORS**  
booth D217, Event Center



**URBAN BARNWOOD**  
booth A125, Event Center



# Thank you to our judges



**LAURA FOX**  
Laura Fox Interiors



**ROSE HOSTETLER**  
Sheyiah Market



**SIERRA BEACHY**  
SB Designs



**RYAN AMSTUTZ**  
Mullwoods



**MAGGIE O'HARE**  
Sherwin Williams



**GARY YODER**  
Dutch Craft Furniture



**SADIE BEACHY**  
S. Flynn Designs



**TONYA SCHLABACH**  
bfearless



**LAVERN HERSHBERGER**  
Abner Henry



**KENDRICK MULLET, EXECUTIVE DIRECTOR**  
director@ohiofurnitureguild.com

OhioFurnitureGuild.com

2025 Ohio Furniture Market Showcase House



We greatly appreciate the partnership with Acroma Pro, Autumn Mill, and M.L. Campbell. Their sponsorship support, and their push towards updating color trends has made the Showcase House possible.



AcromaPro®, Autumn Mill™, and M.L. Campbell® are registered trademarks of the Sherwin-Williams Company.